

# BIAMP UCC-LENOVO TSC2-IP SYSTEM INSTALLATION GUIDE



**UCC LENOVO TSC2-IP-MTR  
UCC LENOVO TSC2-IP-ZOOM**



# IN THE BOX

## UCC-LENOVO TSC2-IP

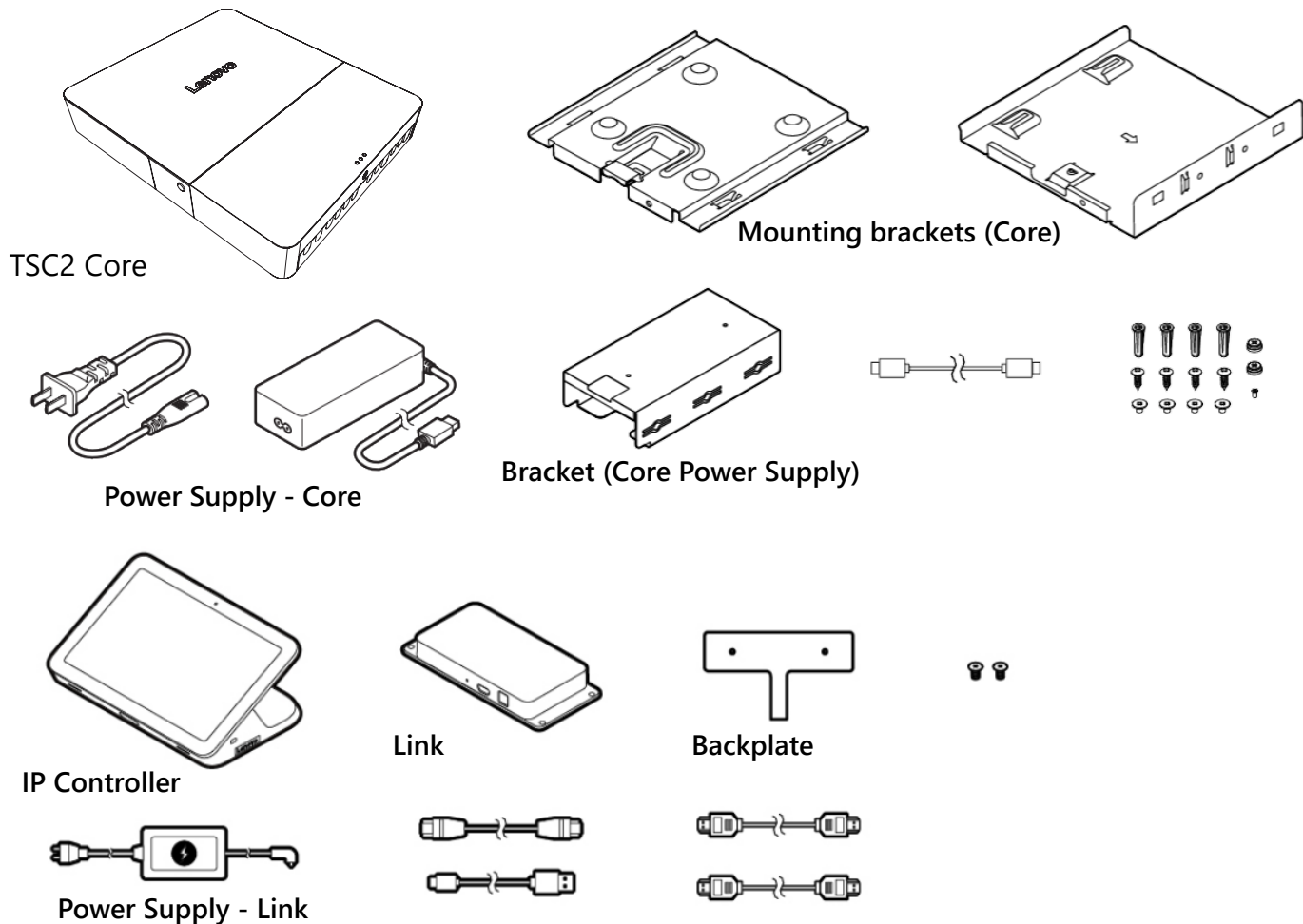

### Suggested for Setup

- Completed checklist form (Teams or Zoom) Form links are in the [TSC2-IP Setup article](#)
- Keyboard & mouse

### Operating Environment

Altitude (without pressurization):

- -15.2 m – 3048 m (-50 ft – 10,000 ft)

Temperature:

- 10°C – 35°C (50°F – 95°F)

Relative Humidity

- 20% – 80% (non-condensing)

### Cables & documentation in the box

- 6-meter (20') CAT5e cable
- 2-meter (6.4') HDMI cable
- 1-meter (3.2') HDMI cable
- 3-meter (9.8') USB-C BYOM cable
- 1-meter (3.2') USB 3.0 Type-B to USB Type-A cable.
- Safety guide

### Setup information

[Lenovo TSC2-IP Installation, Setup & Configuration](#)

# INSTALLATION

There are 3 mounting options for the Core device: [Wall Mount](#), [Under-Table](#) and [on the Table](#)

## WALL MOUNT OPTION

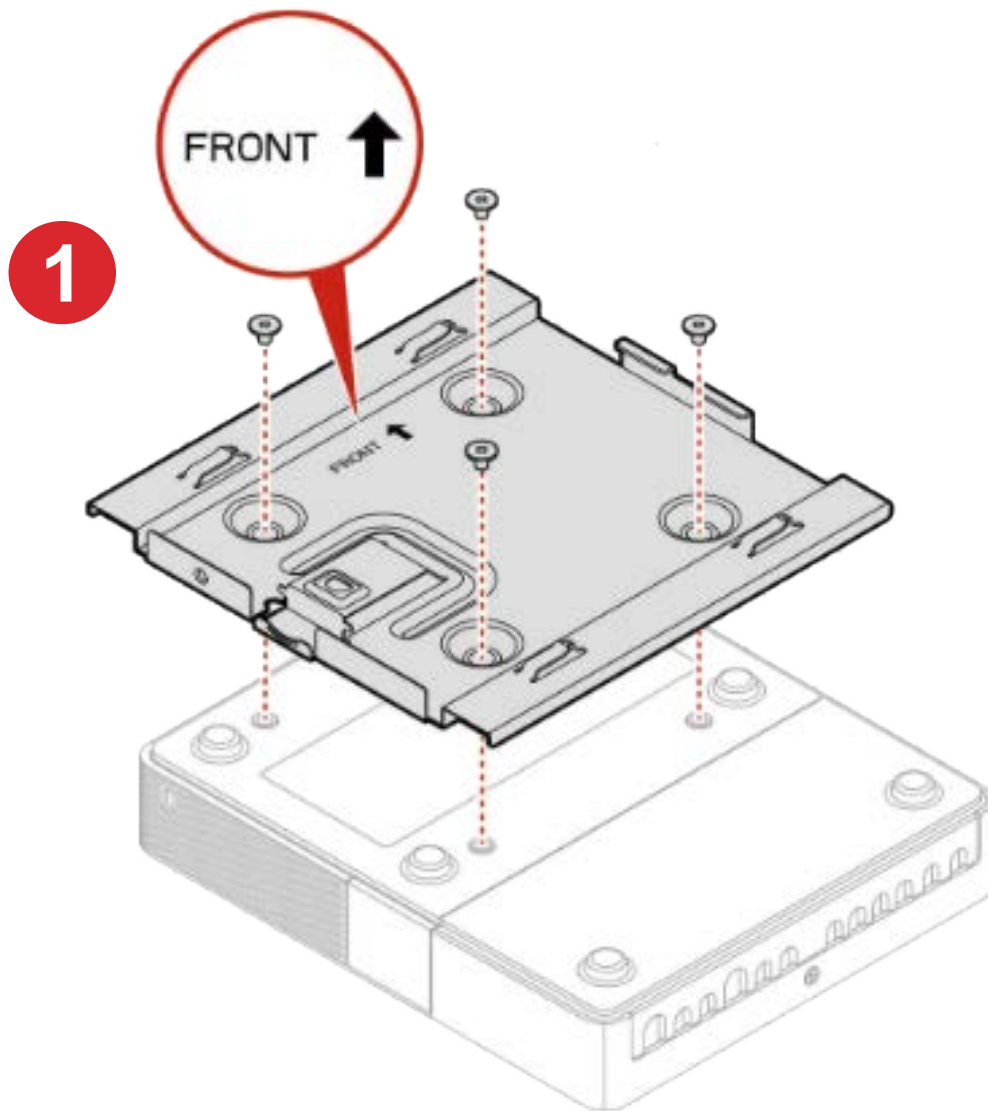

# INSTALLATION

## Wall-Mount Option (continued)

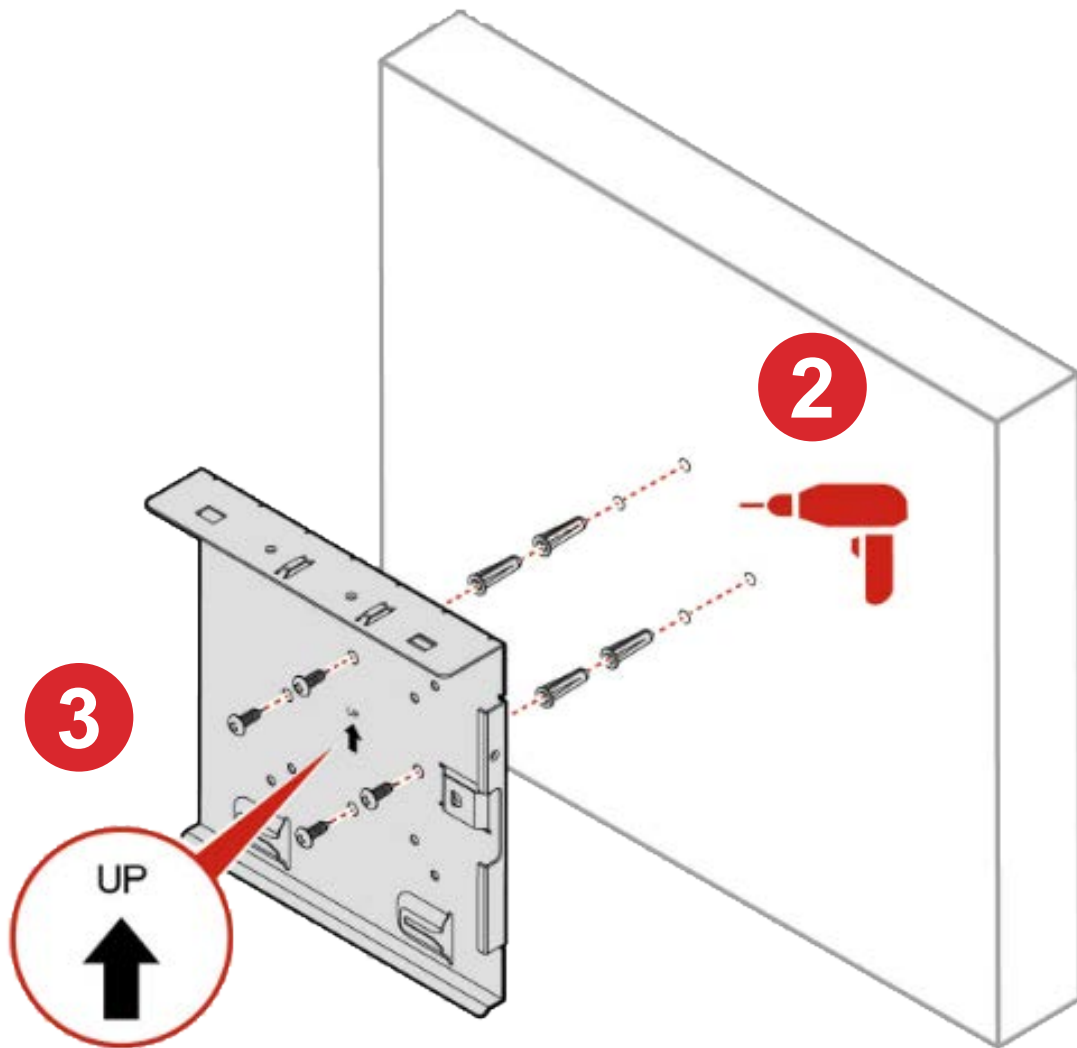

# INSTALLATION

## Wall-Mount Option (continued)

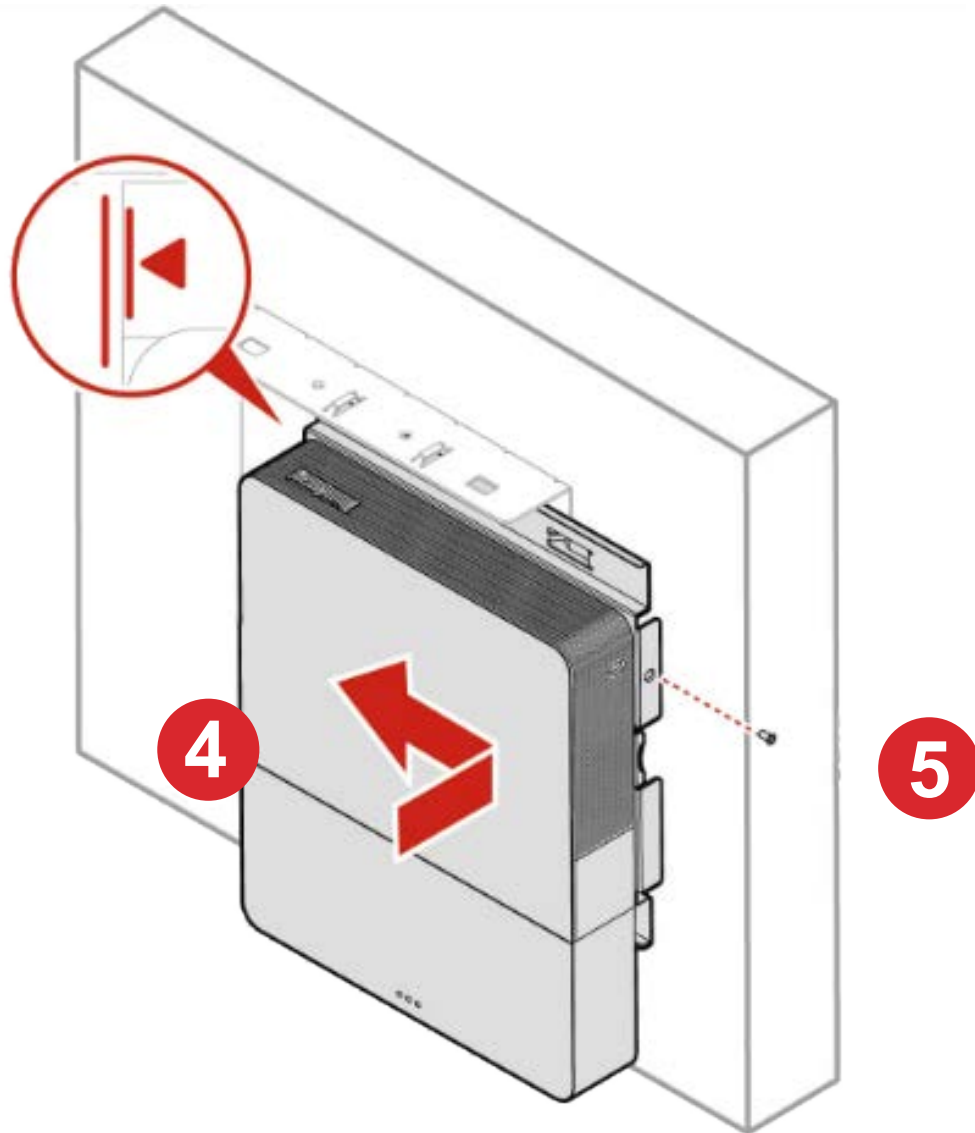

# INSTALLATION

## Wall-Mount Option (continued)

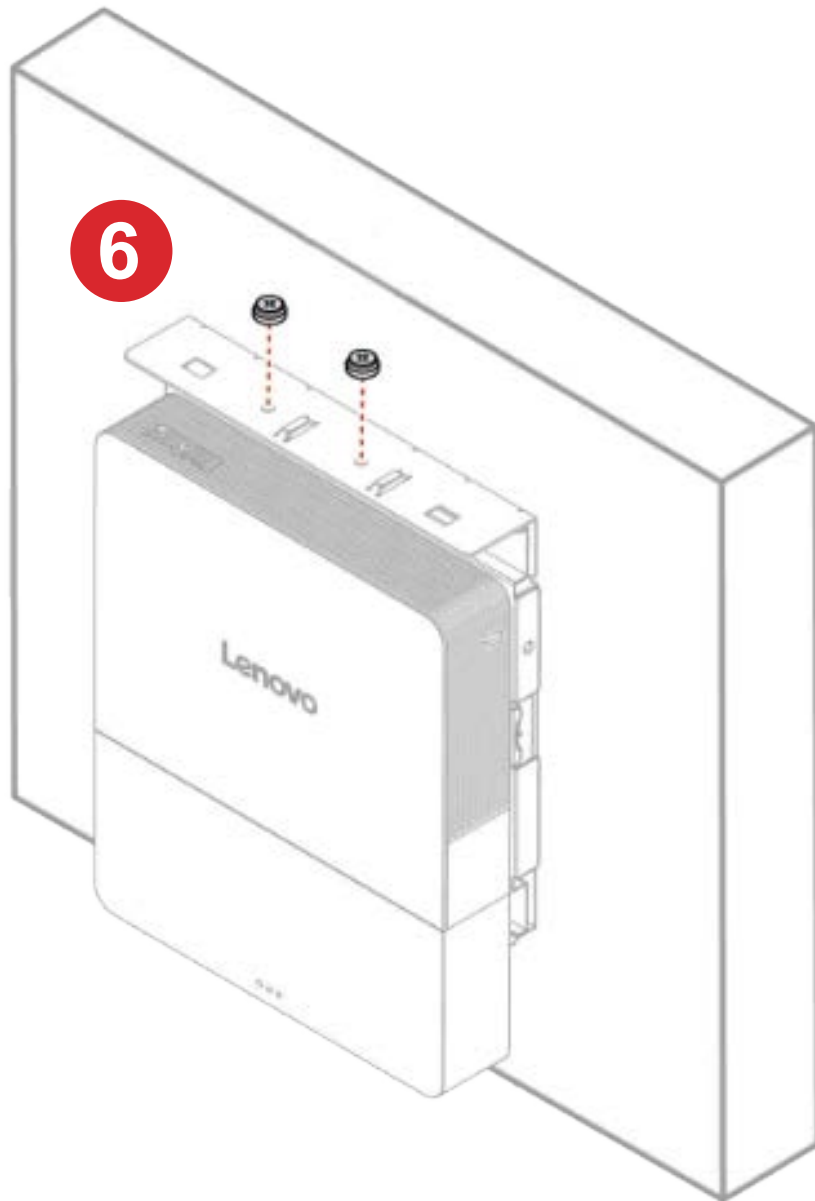

# INSTALLATION

## Wall-Mount Option (continued)

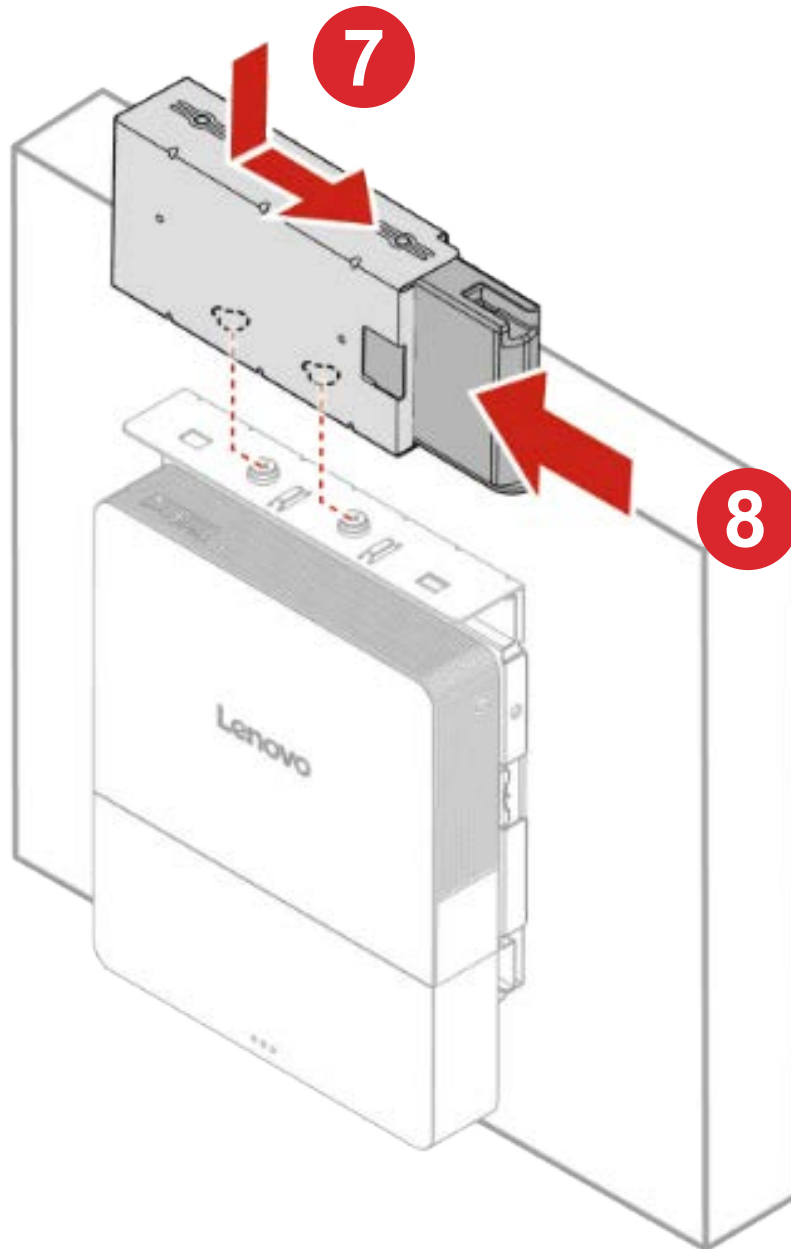

# INSTALLATION

## UNDER-TABLE MOUNT OPTION

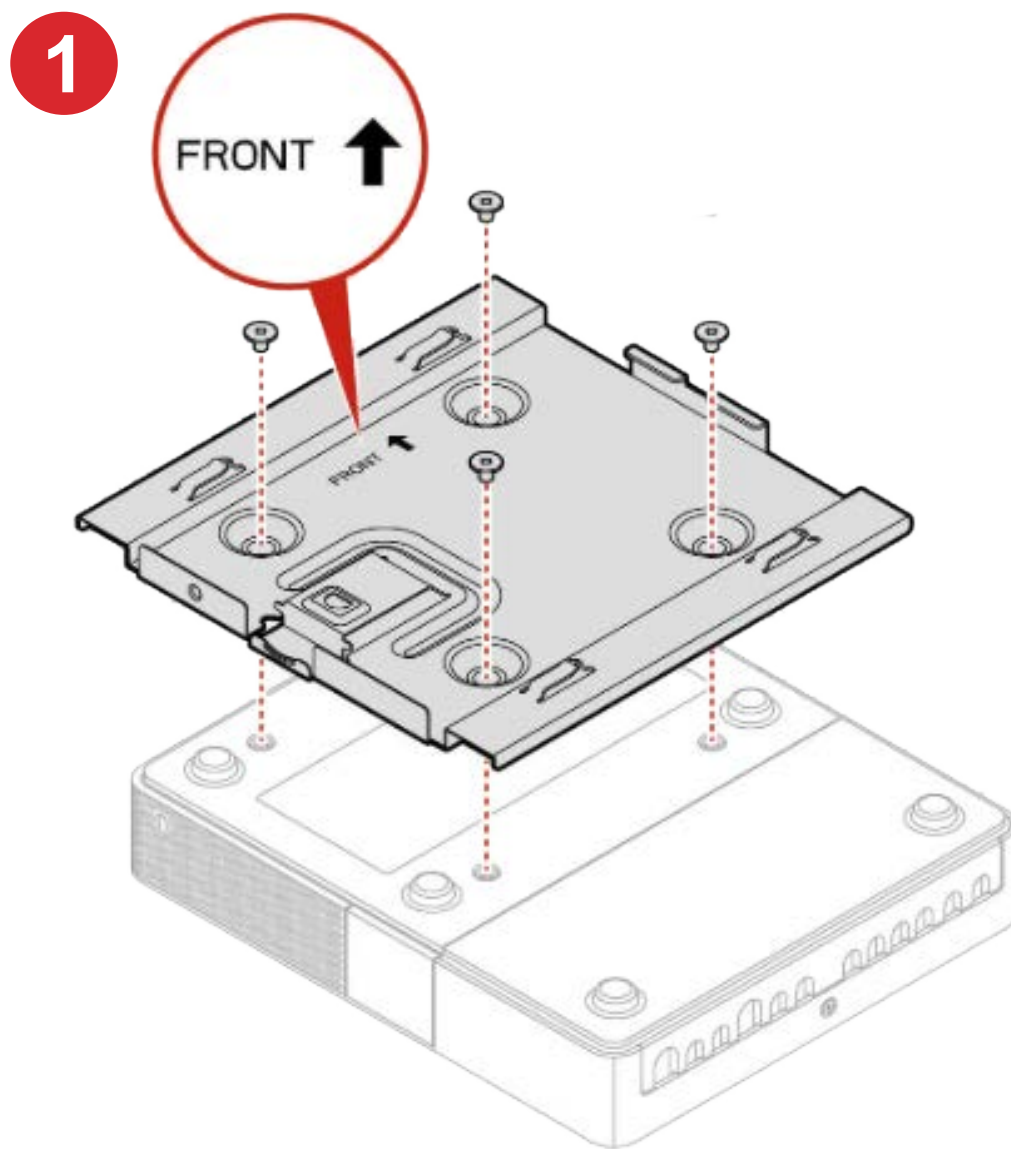



# INSTALLATION

## Under-Table Mount Option (continued)

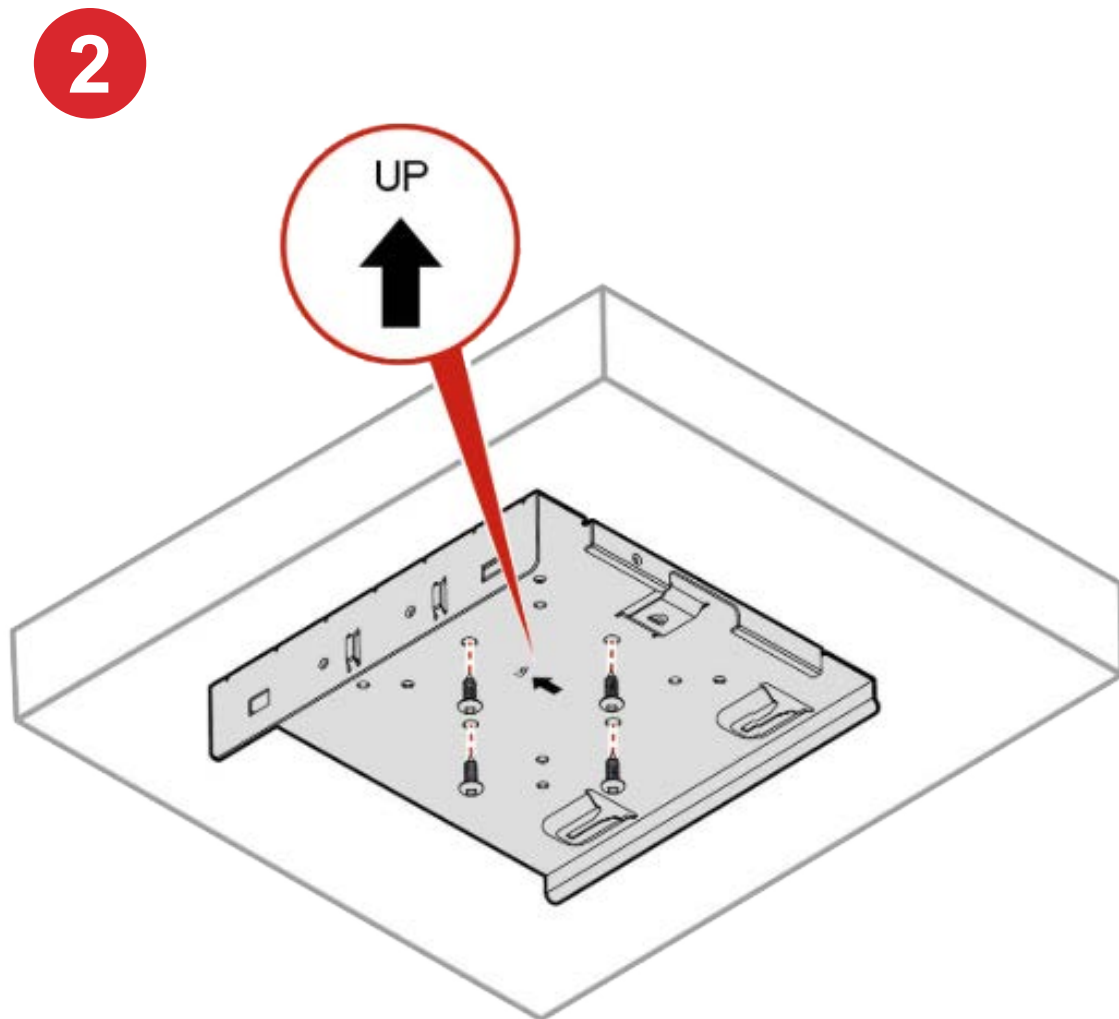

# INSTALLATION

## Under-Table Mount Option (continued)

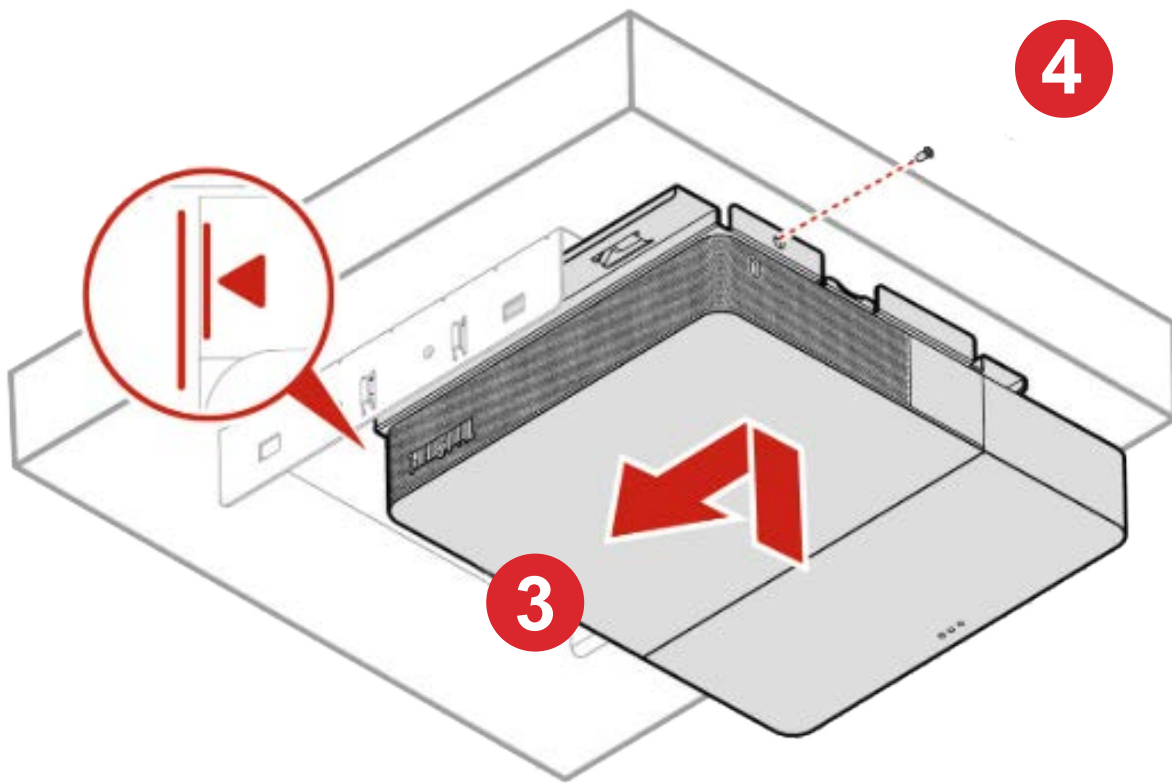

# INSTALLATION

## Under-Table Mount Option (continued)

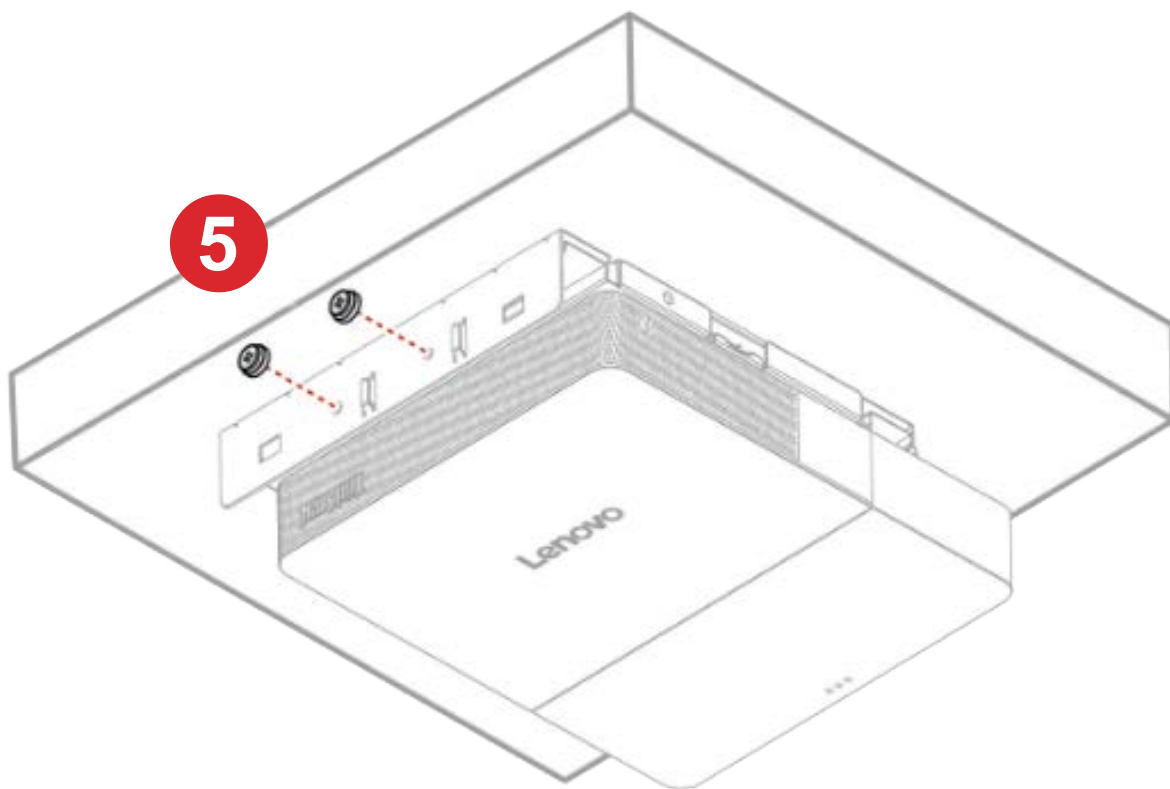

# INSTALLATION

## Under-Table Mount Option (continued)

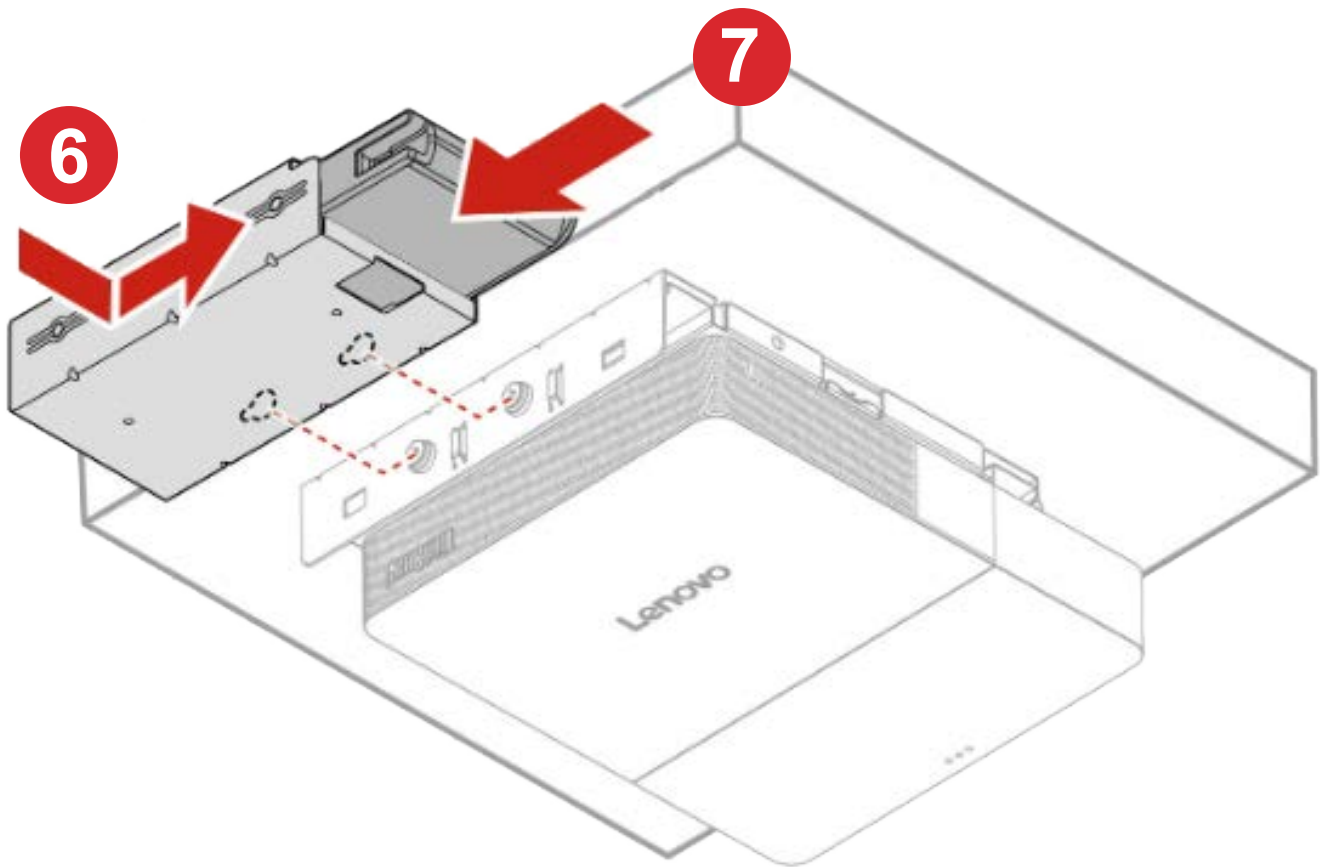

# INSTALLATION

## TABLETOP OPTION

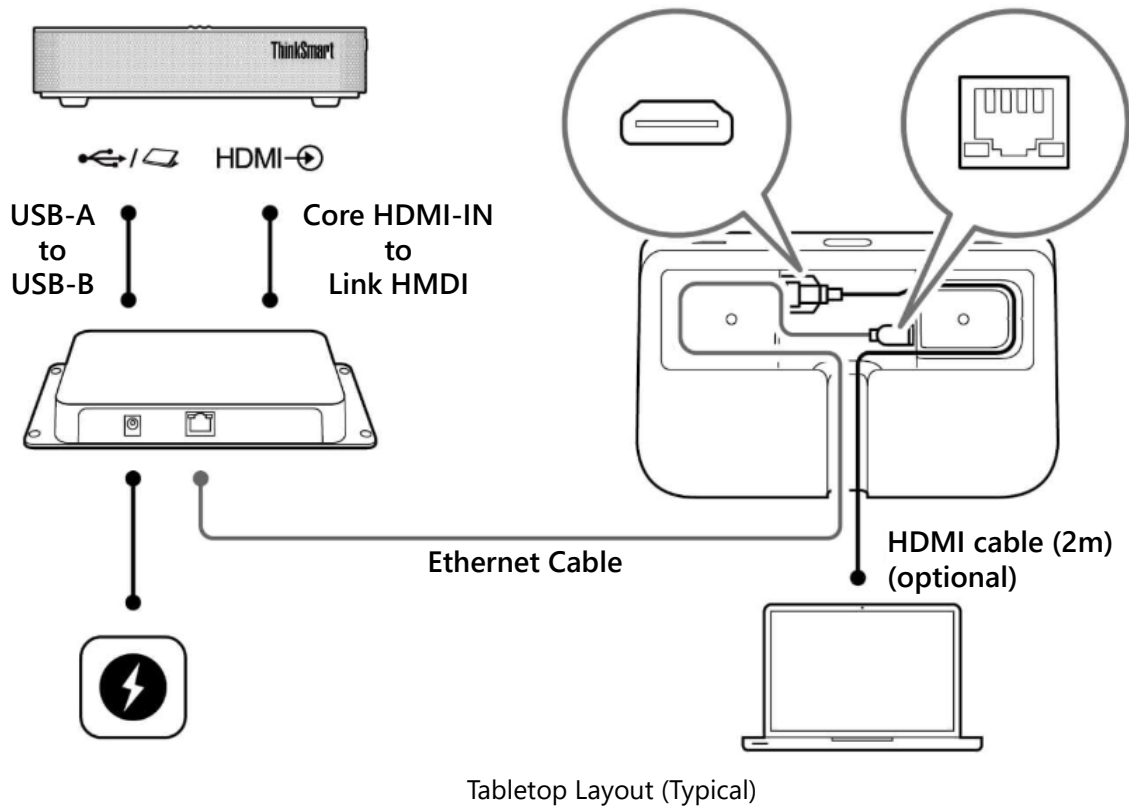

The Core, Link and Controller devices are all placed on the tabletop. The Core and Link will each need to be powered by their power supplies. The Controller is powered by PoE from the ethernet cable from the Link device.

HDMI connection is for a device to share content with the meeting - not a BYOM connection.

# INSTALLATION

## TSC2 CORE

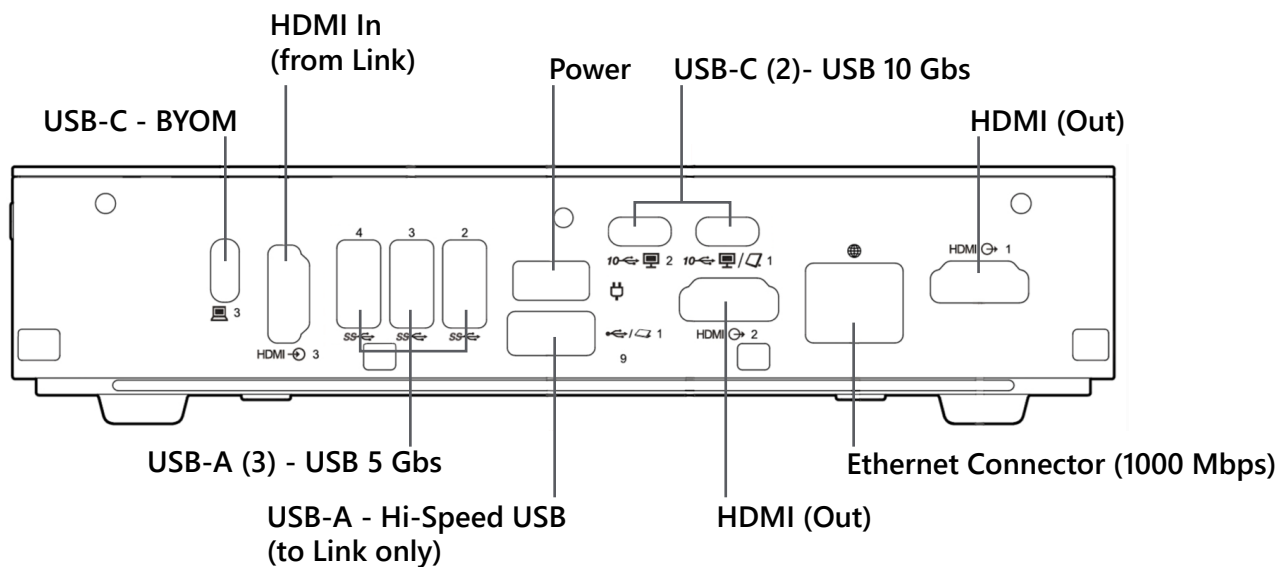
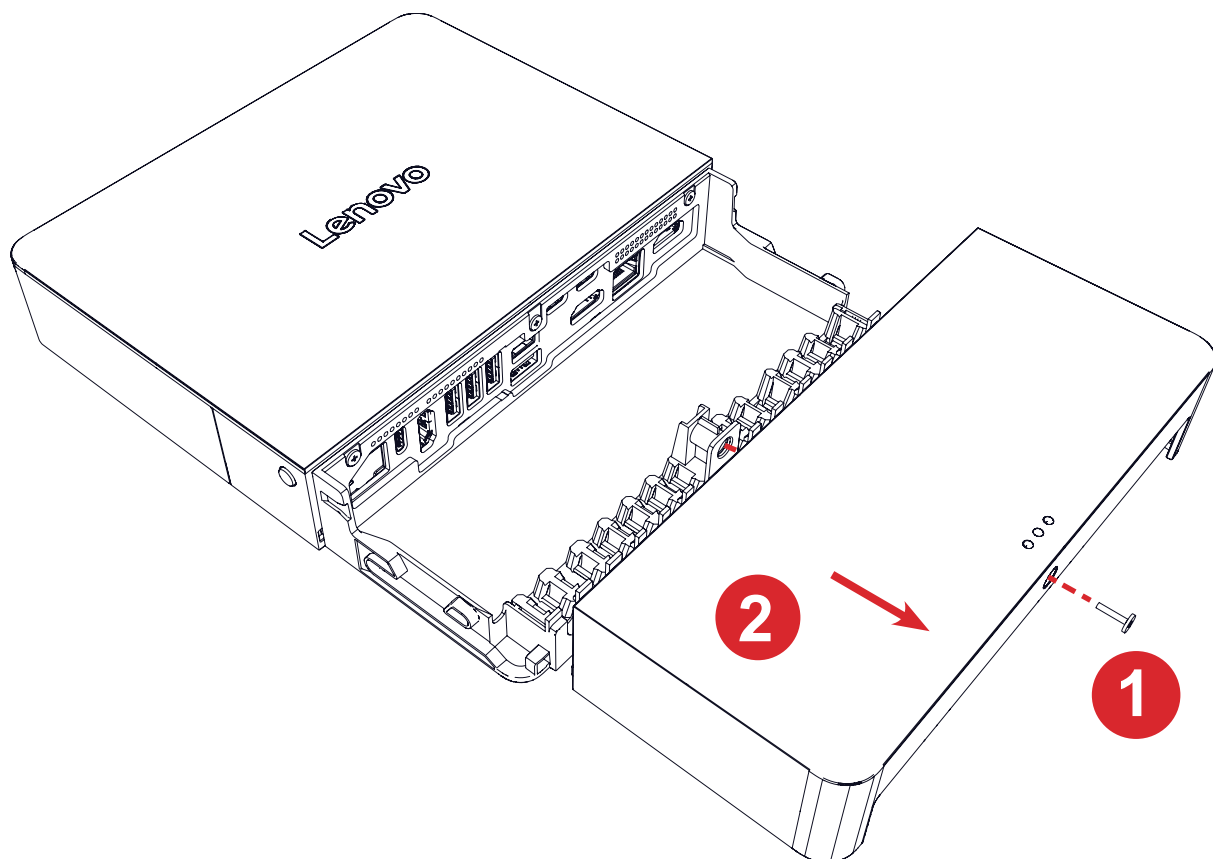

# INSTALLATION

## TSC2 Core (continued)

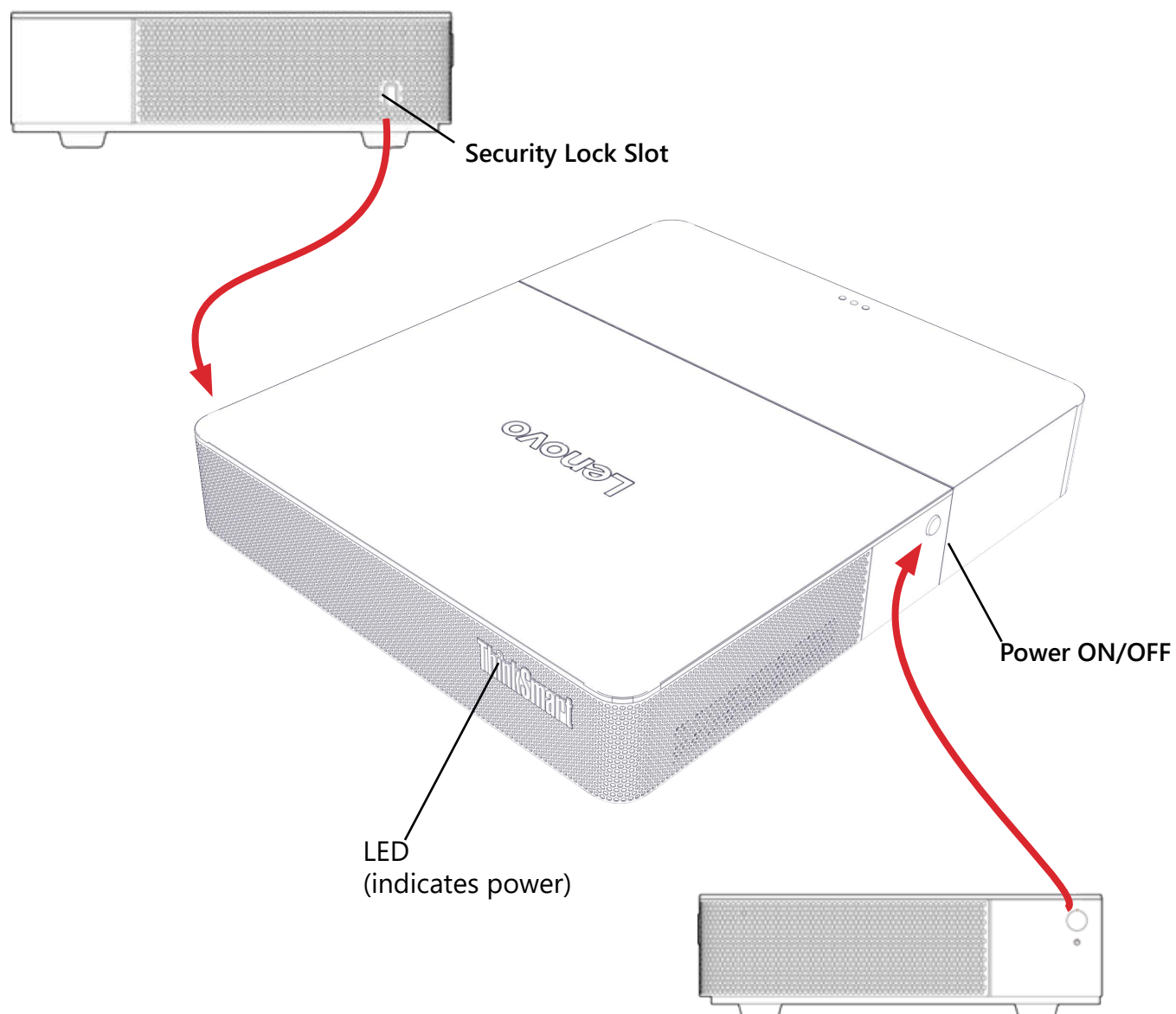

# INSTALLATION

## IP CONTROLLER & LINK

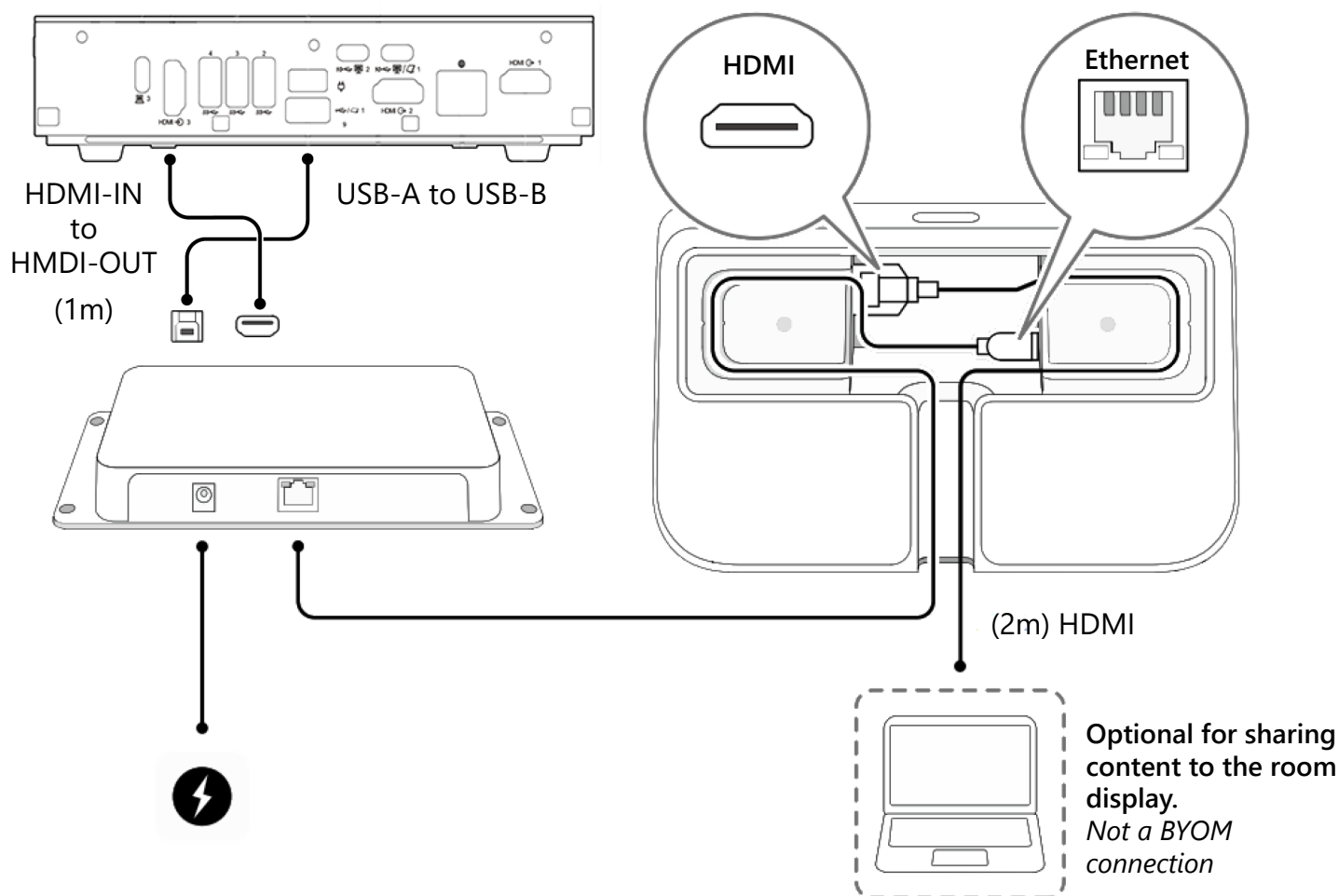

Ignore Link and Controller DIP switches -they do not matter for setup.

When the Core and Link are powered, and CAT5e cables are connected, green LEDs on the Ethernet ports indicate proper connection.



# INSTALLATION

## IP CONTROLLER - INSTALL BACKPLATE

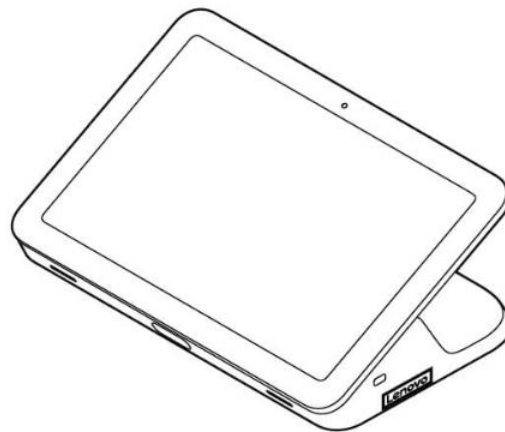
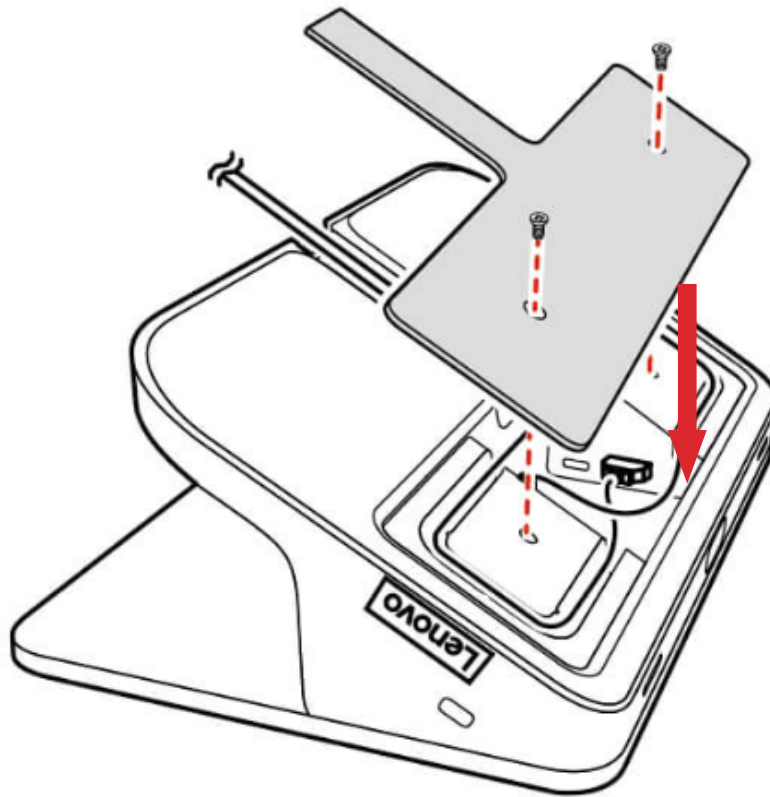

# OPERATION

## SYSTEM SETUP

Connect a keyboard and mouse to the Core for easier navigation and data entry during setup.

Once the system is powered, it may indicate that it will need an update. Allow the system to download and install an update. A reliable connection to the network / internet will be necessary.

Refer to the Cornerstone [TSC2-IP Setup article](#) for further information. The TSC2 system will show on-screen prompts for basic setup. Additional steps will need to be taken to enable BYOM connections. These are explained in the Cornerstone article.

## CONTACT US

Email: [support@biamp.com](mailto:support@biamp.com)

Web: [support.biamp.com](https://support.biamp.com)

Warranty: [biamp.com/legal/warranty-information](https://biamp.com/legal/warranty-information)

Safety & Compliance: [biamp.com/compliance](https://biamp.com/compliance)